

# Central District Specific Plan

## Existing Public Realm Network

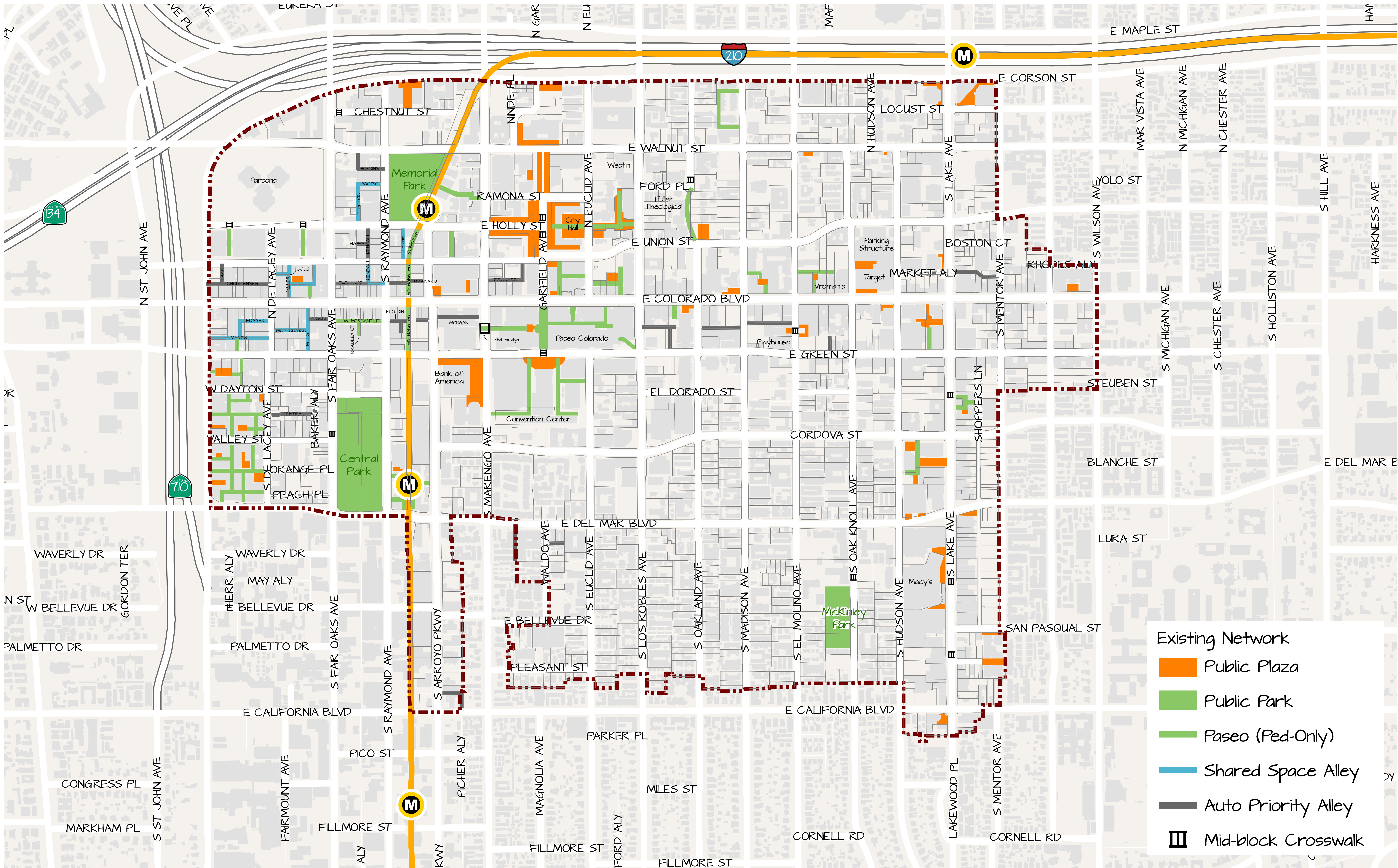

# Central District Specific Plan

## Other Public Realm Plans and Proposals

### OTHER PUBLIC REALM PLANS AND PROPOSALS

Several efforts related to public realm plans, proposals, and future visions for Central District have been developed over many years. These include:

- Old Pasadena Streetscapes and Alley Walkways Refined Concept Plan (1995),
- Pasadena Playhouse District Concept Plan for Streetscapes, Walkways & Alleys (1996),
- Central District Specific Plan (2004),
- The Pasadena Passages Project (2016),
- Playhouse District Strategic Economic Development and Vision Implementation Plan: Transforming the Playhouse District (2018)

The team is aware of these efforts and will consider the plans and proposals in developing the public realm concept for Central District.

### OLD PASADENA STREETSCAPES AND ALLEY WALKWAYS REFINED CONCEPT PLAN (1995)

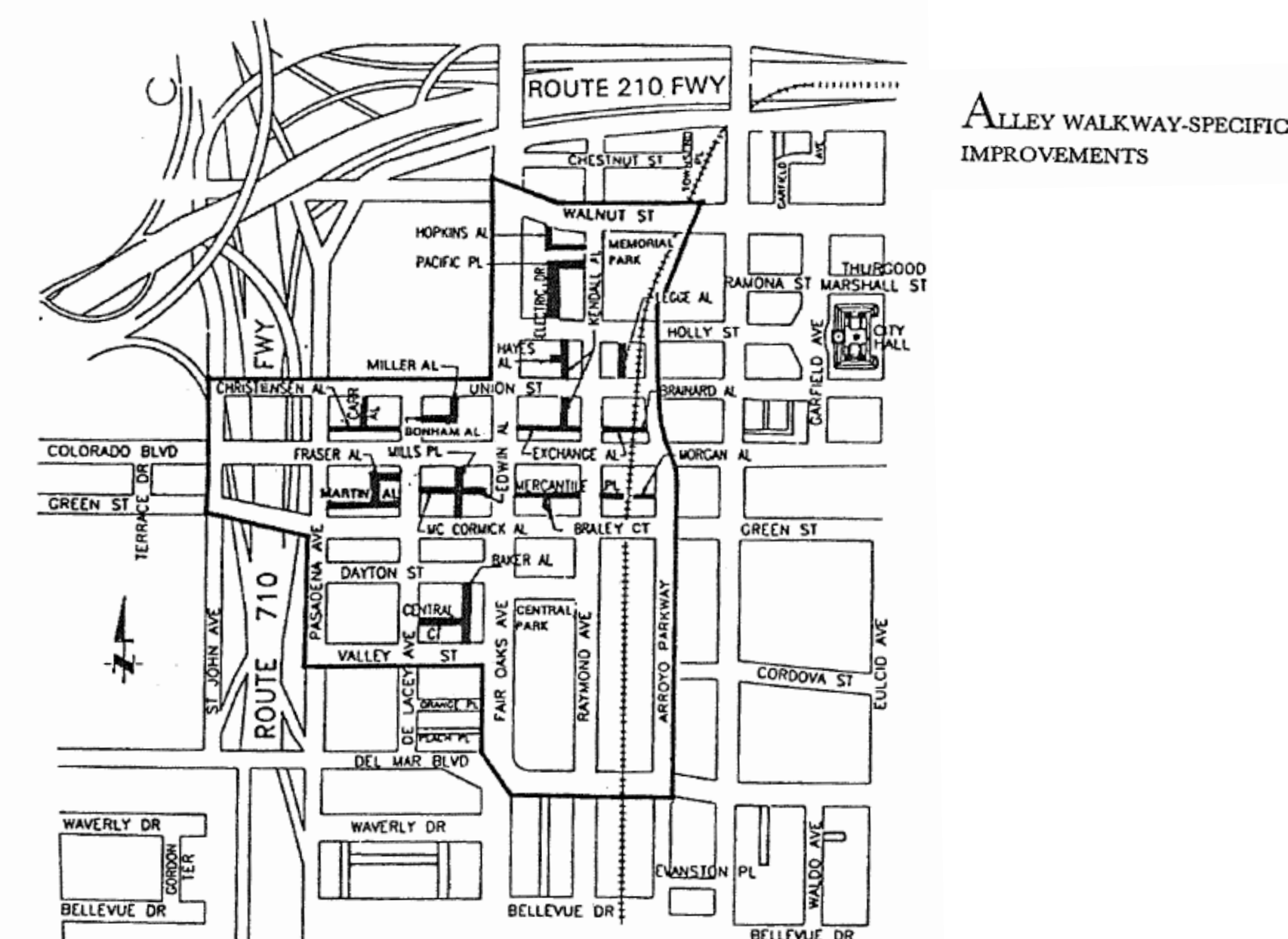
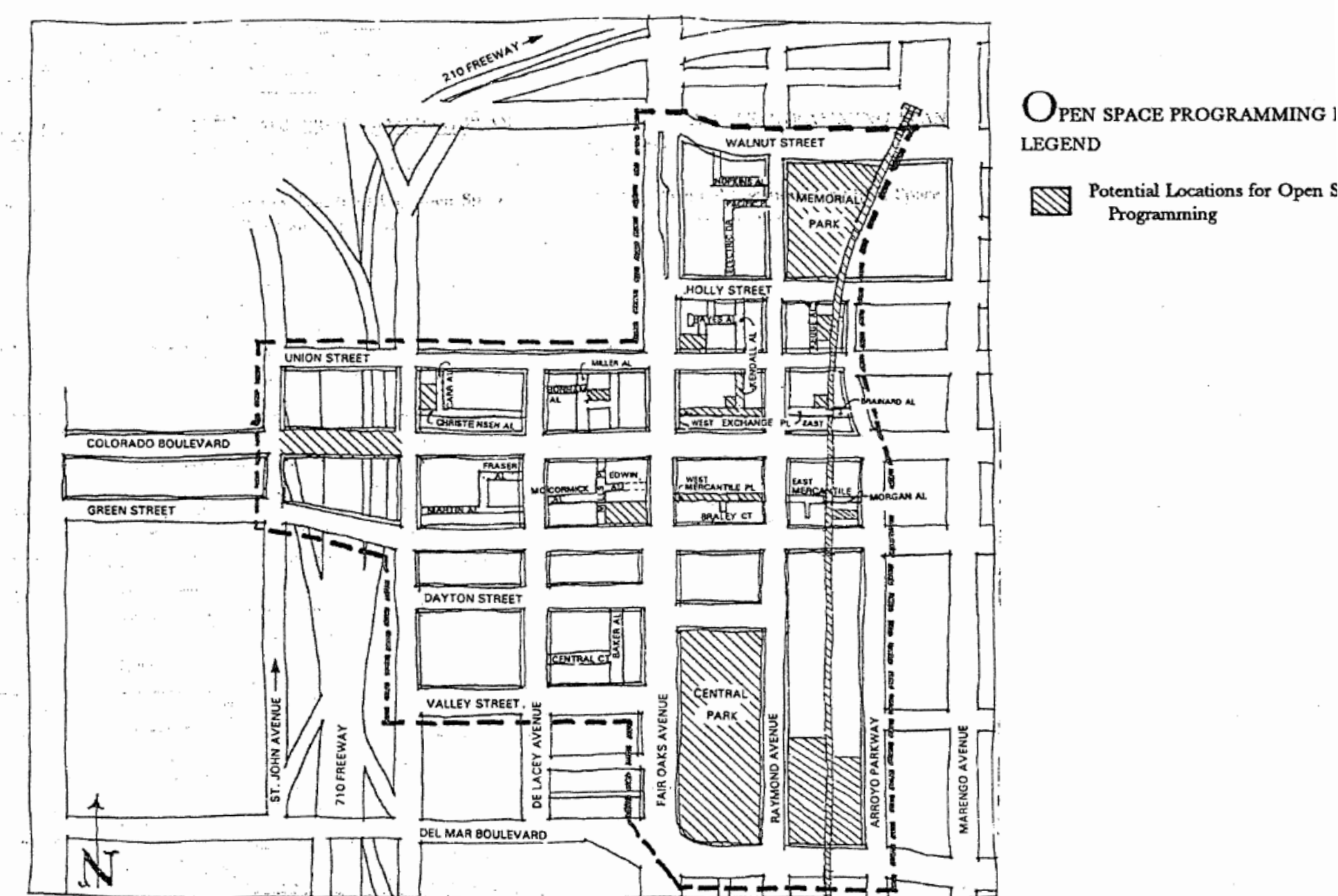

### PASADENA PLAYHOUSE DISTRICT CONCEPT PLAN FOR STREETSCAPES, WALKWAYS & ALLEYS (1996)

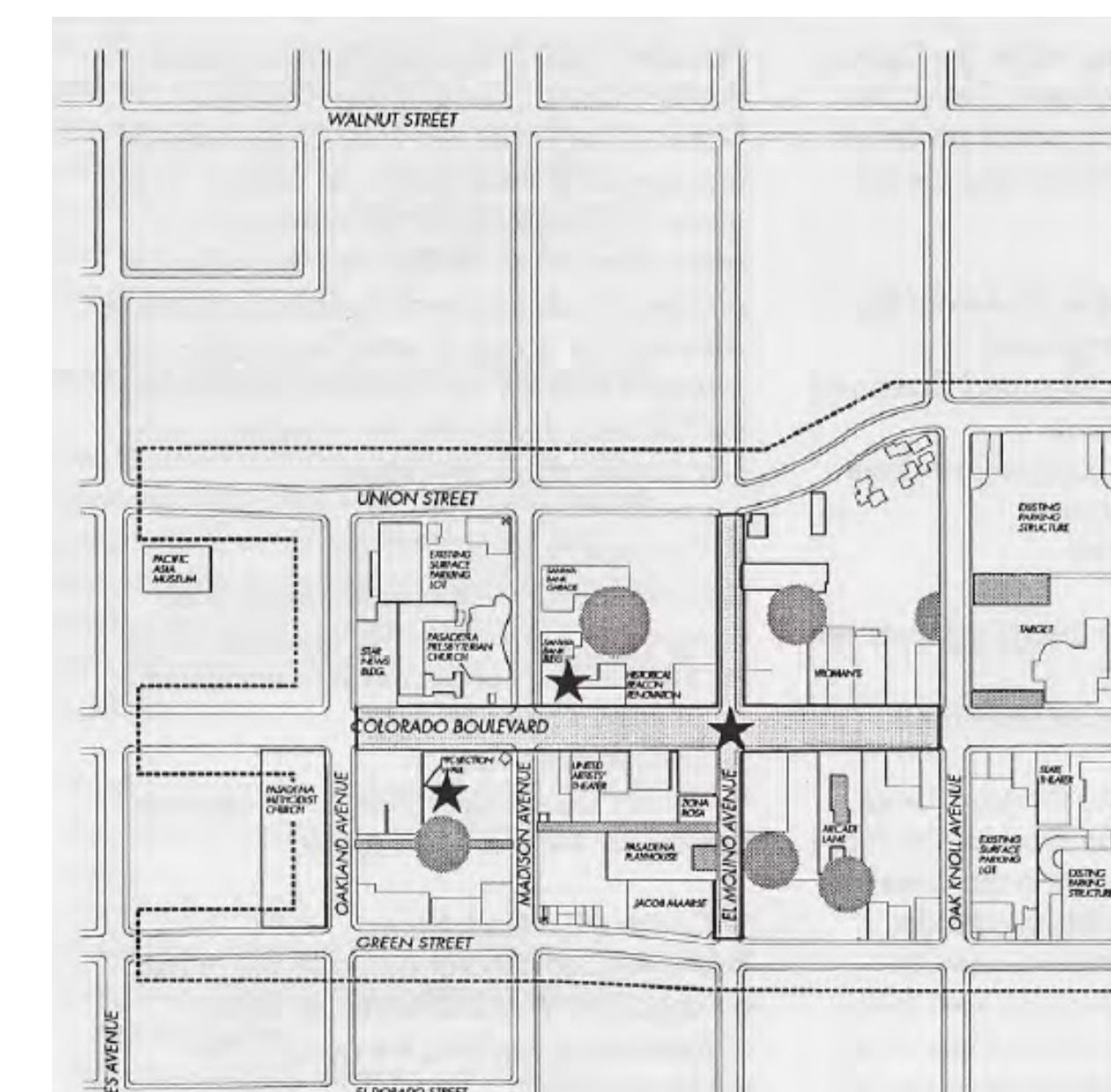

### CENTRAL DISTRICT SPECIFIC PLAN (2004)

#### DISTRICT-WIDE URBAN DESIGN CONCEPT

District-wide Map 22: Public Open Space Concept



### PASADENA PASSAGES PROJECT (2016)



### PLAYHOUSE DISTRICT STRATEGIC ECONOMIC DEVELOPMENT AND VISION IMPLEMENTATION PLAN: TRANSFORMING THE PLAYHOUSE DISTRICT (2018)

#### Streets and Open Space

1. Network of urban parks, plazas and paseos
2. Special designation of entertainment areas: Mentor, El Molino
3. Explore converting one-way streets to two-way
4. Enliven and beautify sidewalk experiences: seating, public art, dining, shade
5. Activate heart of the district: Colorado



#### Design Concepts: Union/El Molino/Banner Bank

- Options for combination of park and parking areas
- Visit the station
- Share your thoughts

